

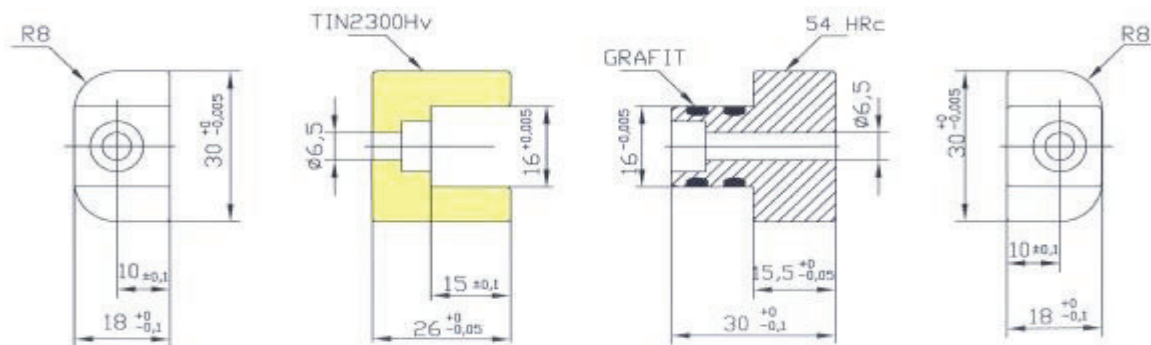

CENTERER REF. 503018



Materials: Steel 1.2344 at 54HRc. + graphite and TiN 2300Hv.

CENTERER REF. 503038

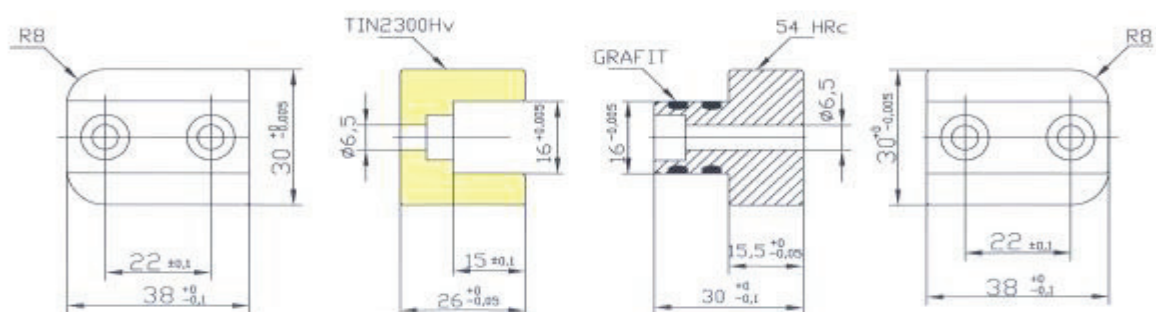

Materials: Steel 1.2344 at 54 HRc. + graphite and TiN 2300 Hv.

Please contact us for any measures different to those included in the catalogue.



CENTERER REF. 505

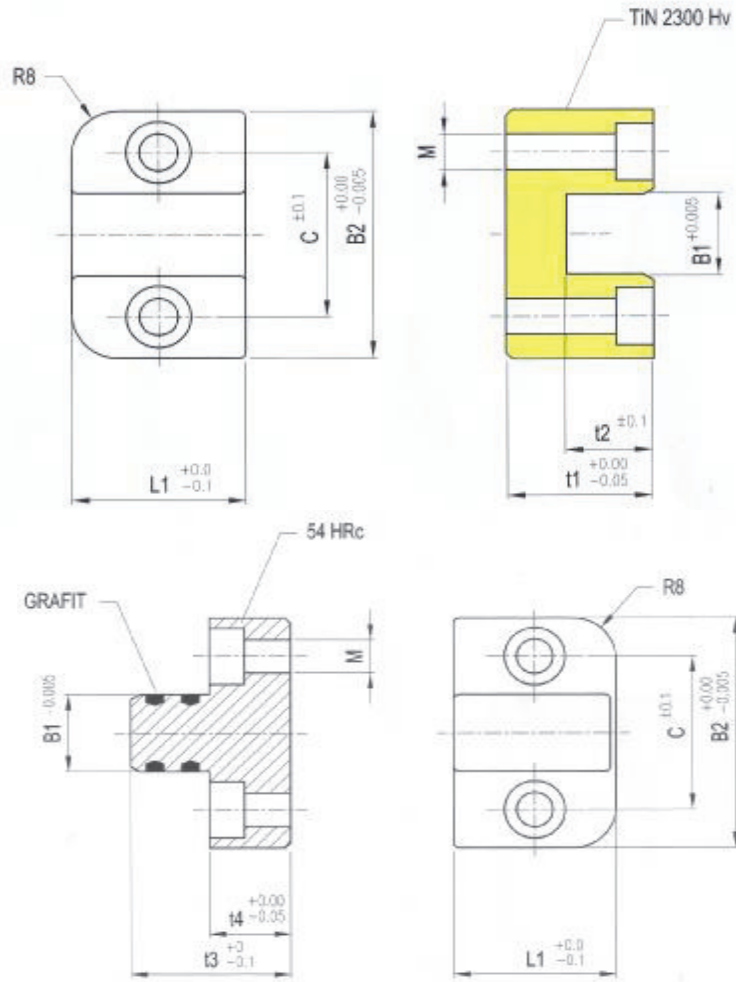

| BOLEXP REF. 505 | | | | | | | | | |
|------------------------|----|----|------|----|----|------|----|-----|-----------|
| B1 | B2 | L1 | C | t1 | t2 | t3 | t4 | M | Item code |
| 11 | 35 | 26 | 23 | 25 | 15 | 29,5 | 15 | M5 | CL505035 |
| 15 | 45 | 30 | 30 | 25 | 15 | 29,5 | 15 | M6 | CL505045 |
| 20 | 55 | 36 | 37,5 | 30 | 20 | 39,5 | 20 | M8 | CL505055 |
| 30 | 75 | 36 | 52 | 35 | 25 | 44,5 | 20 | M10 | CL505075 |

Materials: Steel 1.2344 at 54 HRc. + graphite and TiN 2300 Hv.

Please contact us for any measures different to those included in the catalogue.